

SO MUCH MORE

than a meeting

Crowne Plaza® Kansas City Downtown, conveniently located in the heart of the city's most trendsetting neighborhood offers seamless service and premium accommodations to meet the needs of today's business traveler.



Guest Rooms

- Zones to work, eat and relax
- Large, comfortable beds with quality bedding, pillows and linens

Meeting Rooms

- Natural daylight, Executive Boardrooms, breakout areas
- The latest audio visual technology



Public Spaces

- Distinctive and welcoming sense of arrival
- Well-defined, flexible spaces to meet, work, and relax

Club Lounge

- Exclusive space to work, eat and relax
- Dedicated check-in and complimentary breakfast



Food & Beverage

- Destination bar or restaurant
- International, contemporary brasserie feel

Leisure Facilities

- Well-equipped gym and pool

Meetings & Banquets

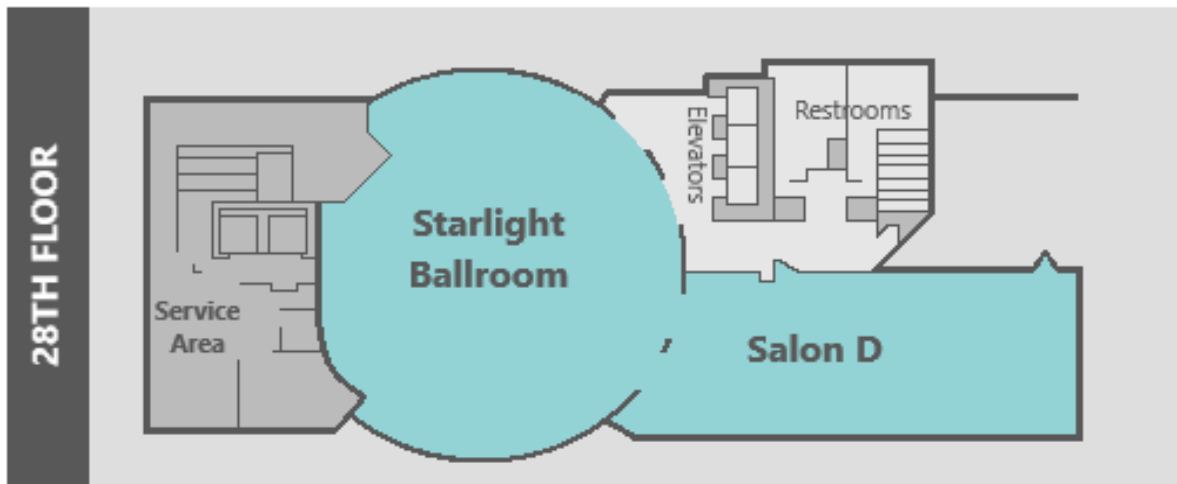
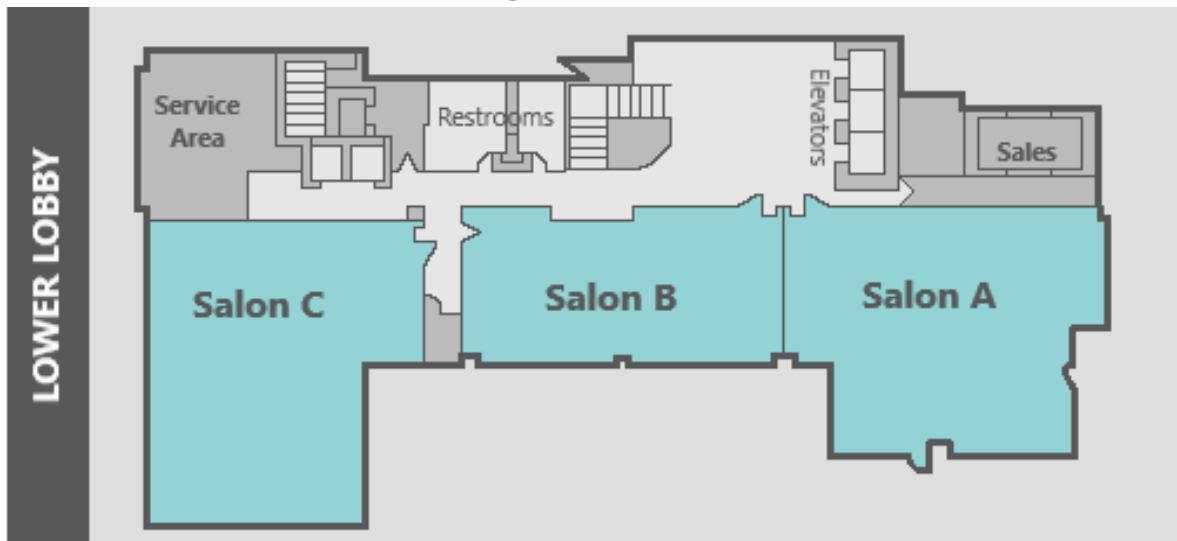

Meeting Room Measurements & Capacities

MEETING ROOMS	SQ. FT.	CEILING HEIGHT	DIMENSIONS	ROUNDS	THEATRE	CLASSROOM	HOLLOW SQUARE	U SHAPE	CONFERENCE
LOWER LOBBY									
SALON A	2,437	8'4"	66' x 42'	190	208	120	54	45	60
SALON B	1,296	8'4"	48' x 27'	80	120	78	42	36	18
SALON C	2,403	8'4"	56' x 49'	140	202	96	54	45	45
25TH FLOOR									
BOARDROOM 2525	446	8'	24' x 18'	30	48	24	30	24	15
26TH FLOOR									
PLAZA WORKSPACE STUDIO	446	8'	24' x 18'	--	--	--	--	--	8
CONCIERGE LOUNGE	1,104	8'	1,104	--	--	--	--	--	--
27TH FLOOR									
BOARDROOM 2701	446	8'	24' x 18'	30	48	24	30	24	15
EXECUTIVE BOARDROOM	446	8'	30' x 52'	--	--	--	--	--	12
28TH FLOOR									
STARLIGHT BALLROOM	3,716	10'2"	60' x 68'	270	325	192	72	54	70
SALON D	1,875	8'9"	64' x 26'	120	150	84	60	54	40