

# KANSAS CITY CONVENTION HOTELS









# 5 REASONS TO EXPERIENCE KANSAS CITY

*An energetic city forged by rich history, Kansas City is brimming with activities to keep you entertained—eclectic cuisine, swinging jazz, one-of-a-kind museums, a thriving arts scene and fantastic shopping. Here are five reasons your group should join the 24 million people that travel to Kansas City each year.*

## 1 LOCATION

- The Heart of America: the country's most centrally located major metropolitan area
- Convenient Airlift: more than 300 flights with non-stop service to 54 destinations
- Accessible Location: 55 million people within a day's drive

## 2 AFFORDABILITY

- Competitive rates for airfare, lodging, transportation, food and services
- A wealth of free and inexpensive cultural attractions, such as three free art museums

## 3 WORLD-CLASS CUISINE

- A culinary crossroads of upscale restaurants, James Beard chefs and farm-to-table favorites
- The Barbecue Capital of the World: more than 100 restaurants in all



## 4 URBAN RENAISSANCE

- Remarkable \$10 billion Downtown transformation
- Free and modern KC Streetcar, with extended line opening in 2025
- New and revitalized hotels
- Acclaimed arts and museums, including the Kauffman Center for the Performing Arts, the National WWI Museum and Memorial and The College Basketball Experience

## 5 ENTERTAINMENT

- Power & Light District: 8-block entertainment hub steps from the Convention Center with more than 50 restaurants/shops and 150 free events annually
- Spanish-inspired Country Club Plaza: 15 blocks of outdoor shopping, dining and entertainment surrounded by dazzling fountains
- Emerging cultural districts like 18th & Vine, Westport, 39th Street and the Crossroads Arts District



*“Kansas City is  
the most lovable  
of cities.”  
— Huffington Post*



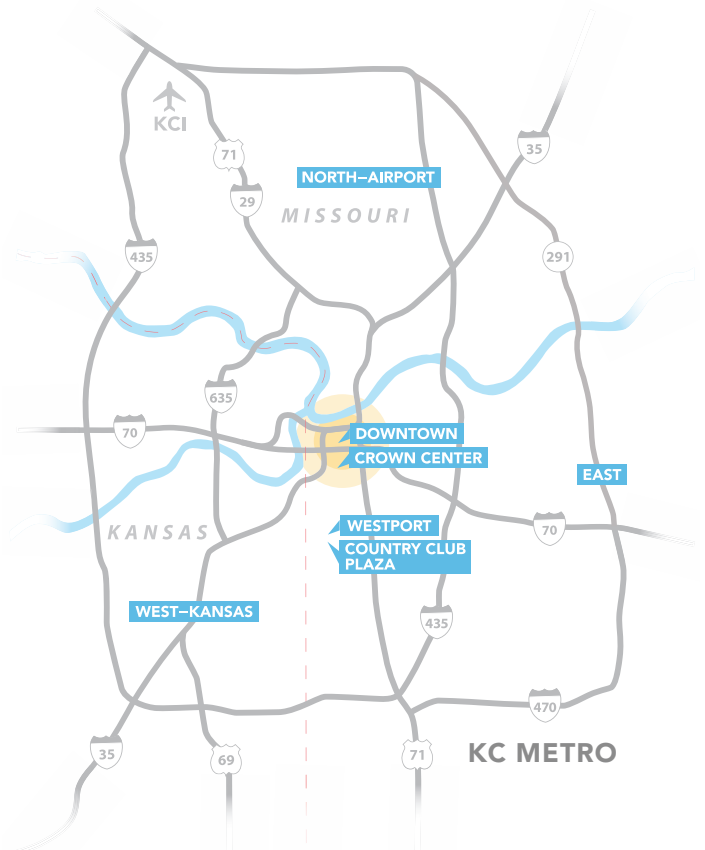
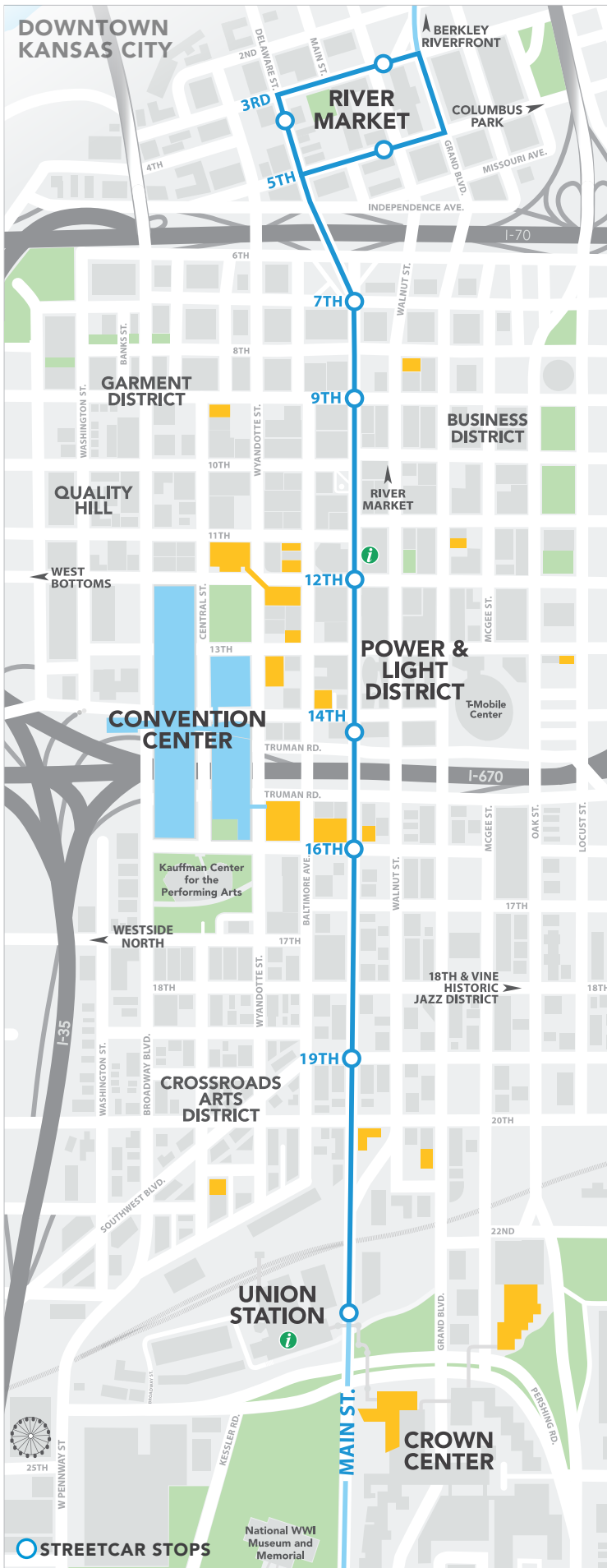

## DOWNTOWN – CROWN CENTER

Amid the skyscrapers and fantastic Art Deco buildings, you'll find a vibrant, new energy in the heart of the city. Just two blocks from the Kansas City Convention Center and downtown hotels is the eight-block **Kansas City Power & Light District**, filled with more than 50 restaurants, bars and entertainment venues. Downtown is also a prime destination for the performing arts with the **T-Mobile Center** arena, a concentration of historic theaters and the **Kauffman Center for the Performing Arts**. Nearby, the international headquarters for **Hallmark Cards**, **Crown Center** is an enclosed complex of more than 60 shops and restaurants, as well as **LEGOLAND Discovery Center** and **SEA LIFE Aquarium**. With so much to do, no wonder *Forbes* called KC one of "America's Best Downtowns." Also nearby: *Union Station*, *National WWI Museum*, *Crossroads Arts District*, *18th & Vine Historic Jazz District* and more.



### KANSAS CITY MARRIOTT DOWNTOWN

200 W 12th St.  
Kansas City, MO 64105

PHONE 816-421-6800  
FAX 816-855-4418  
[marriotthotels.com/mciddt](http://marriotthotels.com/mciddt)

- **970 Rooms** [K/Q: 430 • D/D: 501 • Suites: 39]
- Rooms for Individuals with Disabilities: 25
- Meeting Rooms: 42
- Largest Meeting Space: 17,400 sq.ft.
- Restaurants: 2 [In-room Dining Service]
- Parking Spaces: 636 [Fees: Yes]



### LOEWS KANSAS CITY HOTEL *[Connected to the Kansas City Convention Center]*

1515 Wyandotte St.  
Kansas City, MO 64105

PHONE 816-897-7070  
FAX 816-897-7010  
[loewshotels.com/loews-kansas-city-hotel](http://loewshotels.com/loews-kansas-city-hotel)

- **800 Rooms** [K/Q: 380 • D/D: 374 • Suites: 47]
- Rooms for Individuals with Disabilities: 68
- Meeting Rooms: 22
- Meeting Space: 27,000 sq.ft.
- Restaurants: 3 [In-room Dining Service]
- Parking Spaces: 496 [Fees: Yes]



### SHERATON KANSAS CITY HOTEL AT CROWN CENTER *[Adjoined to Crown Center Exhibit Hall]*

2345 McGee St.  
Kansas City, MO 64108

PHONE 816-841-1000  
FAX 816-435-4193  
[sheratonkansascityhotel.com](http://sheratonkansascityhotel.com)

- **730 Rooms** [K/Q: 370 • D/D: 317 • Suites: 43]
- Rooms for Individuals with Disabilities: 15
- Meeting Rooms: 22
- Largest Meeting Space: 17,487 sq.ft.
- Exhibit Hall: 45,500 sq.ft.
- Restaurants: 2 [In-room Dining Service]
- Parking Spaces: 1,247 [Fees: Yes]



### THE WESTIN KANSAS CITY AT CROWN CENTER

One E Pershing Rd.  
Kansas City, MO 64105

PHONE 816-474-4400  
FAX 816-391-4438  
[westin.com/kansascity](http://westin.com/kansascity)

- **724 Rooms** [K/Q: 292 • D/D: 405 • Suites: 27]
- Rooms for Individuals with Disabilities: 15
- Meeting Rooms: 30
- Largest Meeting Space: 16,090 sq.ft.
- Restaurants: 2 [In-room Dining Service]
- Parking Spaces: 445 [Fees: Yes]



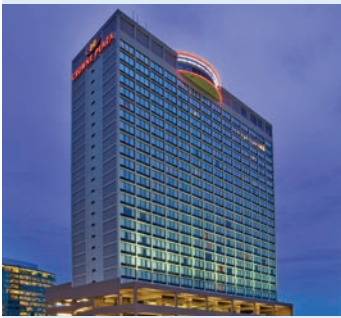

### CROWNE PLAZA KANSAS CITY DOWNTOWN

1301 Wyandotte St.  
Kansas City, MO 64105

PHONE 816-474-6664

FAX 816-460-6690

[crowneplaza.com/kansascitydwtm](http://crowneplaza.com/kansascitydwtm)

- **385 Rooms** [K/Q: 36 • D/D: 250 • Suites: 99]
- Rooms for Individuals with Disabilities: 9
- Meeting Rooms: 10
- Largest Meeting Space: 5,591 sq.ft.
- Restaurants: 1 [In-room Dining Service]
- Parking Spaces: 320 [Fees: Yes]



### COURTYARD BY MARRIOTT & RESIDENCE INN BY MARRIOTT KANSAS CITY DOWNTOWN/CONVENTION CENTER

1535 Baltimore Avenue  
Kansas City, MO 64108

PHONE 816-221-7400

FAX 816-221-1406

[marriott.com/mciks](http://marriott.com/mciks)

- **261 Rooms** [K/Q: 158 • D/D: 94 • Suites: 9]  
(Courtyard: 153 / Residence Inn: 108)
- Rooms for Individuals with Disabilities: 5
- Meeting Rooms: 2
- Largest Meeting Space: 3,056 sq.ft.
- Parking Spaces Available: 155 [Fees: Yes]



### HOTEL PHILLIPS KANSAS CITY, CURIO COLLECTION BY HILTON

106 W 12th St.  
Kansas City, MO 64105

PHONE 816-221-7000

FAX 816-221-3477

[hotelphillips.com](http://hotelphillips.com)

- **217 Rooms** [K/Q: 173 • D/D: 42 • Suites: 2]
- Rooms for Individuals with Disabilities: 12
- Meeting Rooms: 10
- Largest Meeting Space: 1,720 sq.ft.
- Restaurants: 2 [In-room Dining Service]
- Parking Spaces: 50 [Fees: Yes]



CROSSROADS HOTEL





KAUFFMAN CENTER FOR THE PERFORMING ARTS

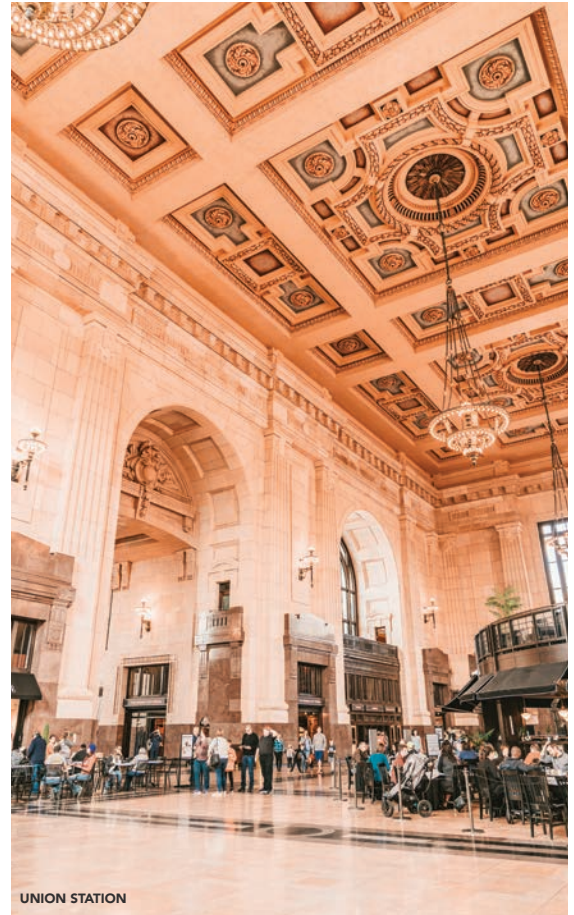

UNION STATION



### HILTON PRESIDENT KANSAS CITY

1329 Baltimore Ave.  
Kansas City, MO 64105

PHONE 816-221-9490  
FAX 816-221-9422  
[presidentkansascity.hilton.com](http://presidentkansascity.hilton.com)

- **213 Rooms** [K/Q: 105 • D/D: 82 • Suites: 26]
- Rooms for Individuals with Disabilities: 11
- Meeting Rooms: 9
- Largest Meeting Space: 4,488 sq.ft.
- Restaurants: 2 [In-room Dining Service]
- Parking Spaces: 130 [Fees: Yes]



### HOTEL KANSAS CITY

1228 Baltimore Ave.  
Kansas City, MO 64105

PHONE 816-685-1228  
FAX 816-685-1229  
[hotelkc.com](http://hotelkc.com)

- **144 Rooms** [K/Q: 82 • D/D: 41 • Suites: 14]
- Rooms for Individuals with Disabilities: 7
- Meeting Rooms: 7
- Largest Meeting Space: 4,100 sq.ft.
- Restaurants: 4 [In-room Dining Service]



### HAMPTON INN & SUITES KANSAS CITY DOWNTOWN CROSSROADS

1571 Main St.  
Kansas City, MO 64108

PHONE 816-255-3915  
FAX 816-255-3971  
[hilton.com](http://hilton.com)

- **132 Rooms** [K/Q: 32 • D/D: 64 • Suites: 36]
- Rooms for Individuals with Disabilities: 8
- Meeting Rooms: 2
- Largest Meeting Space: 764 sq.ft.
- Parking Spaces: 100 [Fees: Yes]





### CROSSROADS HOTEL

2101 Central St.  
Kansas City, MO 64108

PHONE 816-897-8130  
FAX 816-897-8101  
[crossroadshotelkc.com](http://crossroadshotelkc.com)

- **131 Rooms** [K/Q: 92 • D/D: 26 • Suites: 13]
- Rooms for Individuals with Disabilities: 7
- Meeting Rooms: 5
- Largest Meeting Space: 2,933 sq.ft.
- Restaurants: 3 [In-room Dining Service]
- Parking Spaces: 71 [Fees: Yes]



### 21C MUSEUM HOTEL

219 W 9th St.  
Kansas City, MO 64105

PHONE 816-443-4200  
FAX 816-443-4201  
[21cmuseumhotels.com/kansascity](http://21cmuseumhotels.com/kansascity)

- **120 Rooms** [K/Q: 84 • D/D: 17 • Suites: 19]
- Rooms for Individuals with Disabilities: 7
- Meeting Rooms: 7
- Largest Meeting Space: 1,705 sq.ft.
- Restaurants: 1 [In-room Dining Service]



### HOTEL INDIGO KANSAS CITY DOWNTOWN

101 W 11th St.  
Kansas City, MO 64105

PHONE 816-283-8000  
FAX 816-283-8001  
[ihg.com/hotelindigo](http://ihg.com/hotelindigo)

- **118 Rooms** [K/Q: 90 • D/D: 28]
- Rooms for Individuals with Disabilities: 7
- Meeting Rooms: 2
- Largest Meeting Space: 920 sq.ft.
- Restaurants: 1 [In-room Dining Service]
- Parking Spaces: Valet - \$40/day

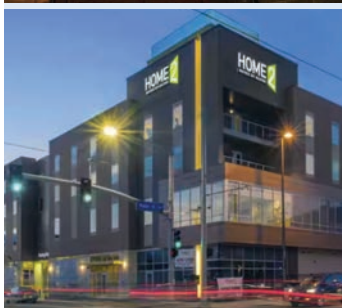

### HOME2 SUITES KANSAS CITY DOWNTOWN

2001 Main St.  
Kansas City, Missouri 64108

PHONE 816-987-7300  
[hilton.com](http://hilton.com)

- **114 Suites**
- Rooms for Individuals with Disabilities: 8
- Meeting Rooms: 1
- Onsite Parking - \$14/day



### AMBASSADOR HOTEL KANSAS CITY, AUTOGRAPH COLLECTION

1111 Grand Blvd.  
Kansas City, MO 64106

PHONE 816-298-7700  
FAX 816-326-7800  
[ambassadorkcmo.com](http://ambassadorkcmo.com)

- **113 Rooms** [K/Q: 90 • D/D: 13 • Suites: 10]
- Rooms for Individuals with Disabilities: 6
- Meeting Rooms: 2
- Largest Meeting Space: 1,566 sq.ft.
- Restaurants: 2 [In-room Dining Service]
- Parking Spaces: 50 [Fees: Yes]



### HOLIDAY INN EXPRESS DOWNTOWN

417 East 13th St.  
Kansas City, Missouri 64106

PHONE 816-474-1000  
[ihg.com/holidayinnexpress](http://ihg.com/holidayinnexpress)

- **73 Rooms** [K/Q: 46 • D/D: 27]
- Rooms for Individuals with Disabilities: 13
- Meeting Rooms: 1
- Largest Meeting Space: 750 sq.ft.
- Parking Spaces: 65 [Fees: Yes]



## COUNTRY CLUB PLAZA – WESTPORT

No trip to Kansas City is complete without a visit to the **Country Club Plaza**. This 15-square-block outdoor shopping and entertainment district is filled with romantic Spanish architecture, European art and dazzling fountains. In addition to being a popular nightlife district, **Westport's** 19th-century

charm remains with historic buildings, old-style lampposts and tree-lined boulevards. Two nationally renowned art museums are found nearby, **The Nelson-Atkins Museum of Art** and the **Kemper Museum of Contemporary Art**. Also nearby: *Kansas City Repertory Theatre* and the *National Museum for Toys & Miniatures*.



### THE INTERCONTINENTAL KANSAS CITY AT THE PLAZA

401 Ward Pkwy.  
Kansas City, MO 64112

PHONE 816-756-1500  
FAX 816-531-1483  
[kansascityic.com](http://kansascityic.com)

- **366 Rooms** [K/Q: 280 • D/D: 66 • Suites: 20]
- Rooms for Individuals with Disabilities: 12
- Meeting Rooms: 20
- Largest Meeting Space: 11,868 sq.ft.
- Restaurants: 1 [In-room Dining Service]
- Parking Spaces: 550 [Fees: Yes]



### MARRIOTT COUNTRY CLUB PLAZA

4445 Main St.  
Kansas City, MO 64111

PHONE 816-531-3000  
FAX 816-531-3007  
[marriott.com/mcipl](http://marriott.com/mcipl)

- **295 Rooms** [K/Q: 165 • D/D: 115 • Suites: 15]
- Rooms for Individuals with Disabilities: 9
- Meeting Rooms: 18
- Largest Meeting Space: 5,628 sq.ft.
- Restaurants: 3 [In-room Dining Service]
- Parking Spaces: 290 [Fees: Yes]



### EMBASSY SUITES COUNTRY CLUB PLAZA

220 W 43rd St.  
Kansas City, MO 64111

PHONE 816-756-1720  
FAX 816-756-3260  
[embassysuites.com](http://embassysuites.com)

- **266 Rooms** [K/Q: 195 • D/D: 71 • Suites: 266]
- Rooms for Individuals with Disabilities: 4
- Meeting Rooms: 12
- Largest Meeting Space: 3,360 sq.ft.
- Restaurants: 1 [In-room Dining Service]
- Parking Spaces: 247 [Fees: No]





### HILTON KANSAS CITY COUNTRY CLUB PLAZA

770 W 47th St.  
Kansas City, MO 64112

PHONE 816-931-4400  
FAX 816-931-3352  
[hilton.com](http://hilton.com)

- **257 Rooms** [K/Q: 192 • D/D: 65 • Suites: 257]
- Rooms for Individuals with Disabilities: 9
- Meeting Rooms: 6
- Largest Meeting Space: 1,302 sq.ft.
- Restaurants: 1 [In-room Dining Service]
- Parking Spaces: 230 [Fees: Yes]



### HAMPTON INN & SUITES COUNTRY CLUB PLAZA

4600 Summit St.  
Kansas City, MO 64112

PHONE 816-448-4600  
FAX 816-448-4610  
[countryclubplazasuities.hamptoninn.com](http://countryclubplazasuities.hamptoninn.com)

- **203 Rooms** [K/Q: 59 • D/D: 99 • Suites: 45]
- Rooms for Individuals with Disabilities: 10
- Meeting Rooms: 7
- Largest Meeting Space: 3,261 sq.ft.
- Restaurants: 0 [No In-room Dining Service]
- Parking Spaces: 226 [Fees: No]



### CASCADE, KANSAS CITY, A TRIBUTE PORTFOLIO HOTEL

4600 Wornall Rd.  
Kansas City, MO 64112

PHONE 816-702-1880  
[marriott.com](http://marriott.com)

- **177 Rooms** [K/Q: 113 • D/D: 38 • Suites: 26]
- Rooms for Individuals with Disabilities: Yes
- Meeting Rooms: 6 + Pre-function Space
- Largest Meeting Space: 4,984 sq.ft.
- Restaurants: 1 [In-room Dining Service]
- Parking Spaces: 290 [Fees: Yes]



### THE FONTAINE

901 W 48th Place  
Kansas City, MO 64112

PHONE 816-753-8800  
FAX 816-753-8891  
[thefontainehotel.com](http://thefontainehotel.com)

- **132 Rooms** [K/Q: 92 • D/D: 30 • Suites: 10]
- Rooms for Individuals with Disabilities: 10
- Meeting Rooms: 6
- Largest Meeting Space: 5,700 sq.ft.
- Restaurants: 1 [No In-room Dining Service]
- Parking Spaces: [Fees: Yes]



### THE RAPHAEL HOTEL, AUTOGRAPH COLLECTION

325 Ward Parkway  
Kansas City, MO 64112

PHONE 816-756-3800  
FAX 816-802-2131  
[raphaelkc.com](http://raphaelkc.com)

- **126 Rooms** [K/Q: 109 • D/D: 17 • Suites: 58]
- Rooms for Individuals with Disabilities: 2
- Meeting Rooms: 2
- Largest Meeting Space: 575 sq.ft.
- Restaurants: 1 [In-room Dining Service]
- Parking Spaces: 100 [Fees: Yes]





## NORTH – AIRPORT

A short drive north will take you to **Zona Rosa**, a shopping and entertainment district in a unique town-square setting. Or, visit the birthplace and the museum of world-famous outlaw Jesse James. Stay at the historic **Elms Resort & Spa**, an Excelsior Springs institution that lists Al Capone and Harry S. Truman as its notable guests. Families love KC's side-by-side amusement parks, **Worlds of Fun** and its splashy sister **Oceans of Fun**. But if the slots and blackjack tables are your idea of entertainment, head for the river. **Ameristar**, **Argosy**, **Harrah's** and **Bally's Kansas City** all offer Vegas-style gaming right in the Heartland. Also nearby: *Briarcliff Village, UFDC Doll Museum, historic Weston, Mo., and more.*



### HARRAH'S CASINO AND HOTEL

One Riverboat Dr.  
North Kansas City, MO 64116

PHONE 816-472-7777  
FAX 816-889-4200  
[harrahsnkc.com](http://harrahsnkc.com)

- **392 Rooms** [K/Q: 183 • D/D: 140 • Suites: 69]
- Rooms for Individuals with Disabilities: 6
- Meeting Rooms: 10
- Largest Meeting Space: 10,000 sq.ft.
- Restaurants: 6 [In-room Dining Service]
- Parking Spaces: 3,394 [Fees: No]



### MARRIOTT KANSAS CITY AIRPORT

775 Brasilia Ave.  
Kansas City, MO 64153

PHONE 816-464-2200  
FAX 816-464-5613  
[marriott.com/mciap](http://marriott.com/mciap)

- **382 Rooms** [K/Q: 226 • D/D: 154 • Suites: 4]
- Rooms for Individuals with Disabilities: 13
- Meeting Rooms: 17
- Largest Meeting Space: 4,510 sq.ft.
- Restaurants: 1 [In-room Dining Service]
- Parking Spaces: 428 [Fees: No]



### HILTON KANSAS CITY AIRPORT

8801 NW 112th St.  
Kansas City, MO 64153

PHONE 816-891-8900  
FAX 816-891-8984  
[kansascityairport.hilton.com](http://kansascityairport.hilton.com)

- **347 Rooms** [K/Q: 145 • D/D: 200 • Suites: 2]
- Rooms for Individuals with Disabilities: 12
- Meeting Rooms: 21
- Largest Meeting Space: 6,570 sq.ft.
- Restaurants: 1 [In-room Dining Service]
- Parking Spaces: 500 [Fees: No]



### ARGOSY CASINO HOTEL & SPA

777 NW Argosy Casino Pkwy.  
Riverside, MO 64150

PHONE 816-746-3100  
FAX 816-746-3716  
[argosykansascity.com](http://argosykansascity.com)

- **258 Rooms** [K/Q: 122 • D/D: 128 • Suites: 8]
- Rooms for Individuals with Disabilities: 10
- Meeting Rooms: 14
- Largest Meeting Space: 7,844 sq.ft.
- Restaurants: 6 [In-room Dining Service]
- Parking Spaces: 1,900 [Fees: No]





### EMBASSY SUITES BY HILTON KANSAS CITY INTERNATIONAL AIRPORT

7640 NW Tiffany Springs Pkwy.  
Kansas City, MO 64453

PHONE 816-891-7788  
FAX 816-801-2229  
[embassysuites.com](http://embassysuites.com)

- **237 Suites**
- Rooms for Individuals with Disabilities: 7
- Meeting Rooms: 15
- Largest Meeting Space: 10,656 sq.ft.
- Restaurants: 1 [In-room Dining Service]
- Parking Spaces: 600 [Fees: No]



### FOUR POINTS BY SHERATON KANSAS CITY AIRPORT

11832 NW Plaza Cir.  
Kansas City, MO 64153

PHONE 816-464-2345  
FAX 816-464-2543  
[starwoodhotels.com/fourpoints](http://starwoodhotels.com/fourpoints)

- **200 Rooms** [K/Q: 97 • D/D: 103 • Suites: 1]
- Rooms for Individuals with Disabilities: 7
- Meeting Rooms: 8
- Largest Meeting Space: 3,000 sq.ft.
- Restaurants: 1 [In-room Dining Service]
- Parking Spaces: 150+ [Fees: No]



### AMERISTAR CASINO HOTEL KANSAS CITY

3200 N Ameristar Dr.  
Kansas City, MO 64161

PHONE 816-414-7000  
FAX 816-414-7250  
[ameristar.com](http://ameristar.com)

- **184 Rooms** [K/Q: 33 • D/D: 92 • Suites: 48]
- Rooms for Individuals with Disabilities: 11
- Meeting Rooms: 6
- Largest Meeting Space: 5,700 sq.ft.
- Restaurants: 12 [In-room Dining Service]
- Parking Spaces: 5,500 [Fees: No]



### THE ELMS RESORT SPA & CONFERENCE CENTER

401 Regent St.  
Excelsior Springs, MO 64024

PHONE 816.630.5500  
FAX 816.630.5350  
[elmshotelandspa.com](http://elmshotelandspa.com)

- **153 Rooms** [K/Q: 86 • D/D: 25 • Suites: 42]
- Rooms for Individuals with Disabilities: 7
- Meeting Rooms: 8
- Largest Meeting Space: 4,005 sq.ft.
- Restaurants: 2 [In-room Dining Service]
- Parking Spaces: 176 [Fees: No]



### HOLIDAY INN KANSAS CITY AIRPORT *[Adjomed to KCI Expo Center]*

11728 NW Ambassador Dr.  
Kansas City, MO 64153

PHONE 816-801-8400  
FAX 816-801-8401  
[holidayinn.com](http://holidayinn.com)

- **141 Rooms** [K/Q: 91 • D/D: 49 • Suites: 1]
- Rooms for Individuals with Disabilities: 7
- Meeting Rooms: 12
- Largest Meeting Space: 1,550 sq.ft.
- KCI Expo Center: 70,000 sq.ft.
- Restaurants: 1 [In-room Dining Service]
- Parking Spaces: [Fees: No]



### COURTYARD MARRIOTT AT BRIARCLIFF

4000 North Mulberry Drive  
Kansas City, MO 64116

PHONE 816841-3300  
FAX 816-587-1305  
[marriott.com](http://marriott.com)

- **123 Rooms** [K/Q: 40 • D/D: 59 • Suites: 24]
- Rooms for Individuals with Disabilities: 8
- Meeting Rooms: 12
- Largest Meeting Space: 7,200 sq.ft.
- Restaurants: 1 [In-room Dining Service: No]
- Parking Spaces: [Fees: No]



## EAST

On the eastern side of the city, Jackson County's **Truman Sports Complex** is home to major-league sports action for the **Kansas City Chiefs** and **Royals** at the side-by-side **Arrowhead** and **Kauffman** stadiums. Further east is Independence, the town that the 33rd U.S. president called home. Attractions

include the **Harry S. Truman Library and Museum**, the **Truman Home**, Victorian mansions, an 1850s jail and a vibrant historic square. *Also nearby: National Frontier Trails Museum, CoCo Key Water Resort, Mormon Visitors Center and more.*



POWELL GARDENS

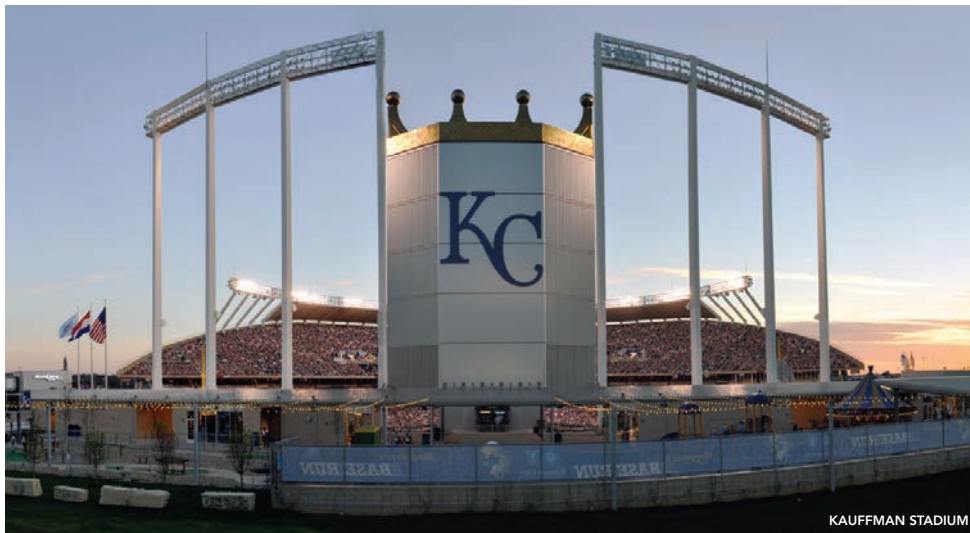

KAUFFMAN STADIUM



### DRURY INN & SUITES KANSAS CITY-INDEPENDENCE

20300 E 42nd Street  
Blue Springs, MO 64015

PHONE 816-795-9393  
FAX 816-655-4253  
[druryhotels.com](http://druryhotels.com)

- **180 Rooms** [K/Q: 44 • D/D: 112 • Suites: 24]
- Rooms for Individuals with Disabilities: 8
- Meeting Rooms: 2
- Largest Meeting Space: 2,184 sq.ft.
- Restaurants: 0 [In-room Dining Service: No]
- Parking Spaces: 100 [Fees: No]



### BEST WESTERN PREMIER KC SPORTS COMPLEX HOTEL

4011 Blue Ridge Cutoff  
Kansas City, MO 64133

PHONE 816-353-5300  
FAX 816-353-1199  
[fourpoints.com/kansascitysportscomplex](http://fourpoints.com/kansascitysportscomplex)

- **167 Rooms** [K/Q: 66 • D/D: 93]
- Rooms for Individuals with Disabilities: 8
- Meeting Rooms: 6
- Largest Meeting Space: 2,400 sq.ft.
- Restaurants: 1 [In-room Dining Service]
- Parking Spaces: 300 [Fees: No]



### COURTYARD KANSAS CITY EAST - BLUE SPRINGS [Adjoined to Adams Pointe Conference Center]

1500 NE Coronado Dr.  
Blue Springs, MO 64014

PHONE 816-228-8100  
FAX 816-228-4606  
[marriott.com](http://marriott.com)

- **121 Rooms** [K/Q: 86 • D/D: 32 • Suites: 3]
- Rooms for Individuals with Disabilities: 12
- Meeting Rooms: 11
- Largest Meeting Space: 7,936 sq.ft.
- Restaurants: 1 [In-room Dining Service]
- Parking Spaces: [Fees: No]



## WEST (KANSAS)

The Kansas side of the metropolitan area is characterized by its convenient amenities and beautiful suburban surroundings. Take, for example, the many quaint areas devoted to charming shops and restaurants—**Village West, Prairie Village, Corinth Square, Town Center Plaza, Prairiefire** and **Park Place** to name a few. Other visitor destinations include the **Children's Mercy Park, New Theatre Restaurant, Nerman Museum of Contemporary Art, Shawnee Town** and many others. Also nearby: *Deanna Rose Children's Farmstead, Johnson County Museum of History, Shawnee Mission Park* and more.



OVERLAND PARK ARBORETUM AND BOTANICAL GARDENS



PRAIRIEFIRE



### SHERATON OVERLAND PARK HOTEL AT THE CONVENTION CENTER

6100 College Blvd.  
Overland Park, KS 66211

PHONE 913-234-2100  
FAX 913-234-2111  
[sheratonoverlandpark.com](http://sheratonoverlandpark.com)

- **412 Rooms** [K/Q: 198 • D/D: 196 • Suites: 18]
- Rooms for Individuals with Disabilities: 10
- Meeting Rooms: 14
- Largest Meeting Space: 10,800 sq.ft.
- Restaurants: 1 [In-room Dining Service]
- Parking Spaces: 418 [Fees: No]



### MARRIOTT OVERLAND PARK

10800 Metcalf Ave.  
Overland Park, KS 66210

PHONE 913-451-8000  
FAX 913-451-1547  
[overlandparkmarriott.com](http://overlandparkmarriott.com)

- **398 Rooms** [K/Q: 207 • D/D: 184 • Suites: 7]
- Rooms for Individuals with Disabilities: 7
- Meeting Rooms: 17
- Largest Meeting Space: 10,010 sq.ft.
- Restaurants: 3 [In-room Dining Service]
- Parking Spaces: 504 [Fees: No]



### DOUBLETREE KANSAS CITY - OVERLAND PARK

10100 College Blvd.  
Overland Park, KS 66210

PHONE 913-451-6100  
FAX 913-451-6463  
[KansasCityOverlandParkDoubletree.com](http://KansasCityOverlandParkDoubletree.com)

- **356 Rooms** [K/Q: 152 • D/D: 187 • Suites: 17]
- Rooms for Individuals with Disabilities: 17
- Meeting Rooms: 19
- Largest Meeting Space: 9,000 sq.ft.
- Restaurants: 1 [In-room Dining Service]
- Parking Spaces: 625 [Fees: No]





*For more information about planning  
a meeting in Kansas City, please call:*

**VISIT KC**

1100 Walnut Street  
Suite 3450 A  
Kansas City, MO 64106  
816-691-3800 • 877-528-4748

**VISITKC.COM/MEETINGS**

    @VisitKC

*Cover photo: Loews Kansas City Hotel*

